

# UTL UHG COUPLINGS

(Half Gear Couplings)

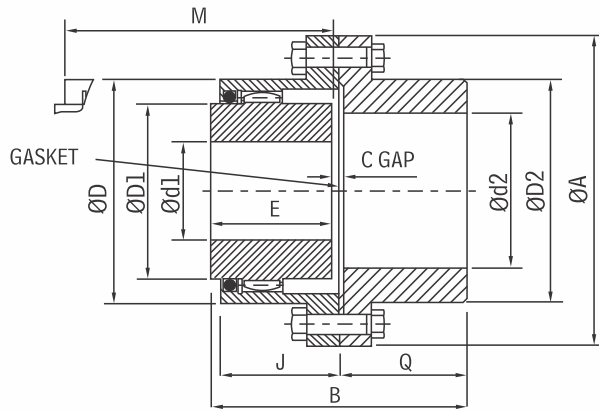

## FEATURES

- Less Backlash
- Compact Assembly
- Larger Bore Capacities
- High Power To Weight Ratio
- Accommodates Angular, Parallel and Axial Misalignments
- Generally used up to 120° C. Can be used for higher temperatures by using proper grade of grease or oil
- Standard half flexible gear coupling TYPE UHG cannot accommodate parallel misalignment.
- Used primarily with floating shaft assemblies. Extensively used for cross traverse and long travel line shaft drives.

## Dimensions & Technical Data

Size	kW at 100 rpm	Rated Torque Nm	Max. rpm	Bore		Dimensions are in mm											Solid Hub	
				PB	Max.		ØA	E	ØD1	ØD	M	C	J	B	Q	ØD2	Wt. kg	M.I. (WR <sup>2</sup> ) kg-m <sup>2</sup>
					Ød1	Ød2												
100	5.2	497	7600	10	35	45	120	45	50	75	55	3	39.5	93	46.5	65	4.2	0.0075
101	10.5	1002	6300	20	50	60	170	55	65	110	65	5	49	115	57.5	85	11	0.0375
102	26.1	2492	5000	30	60	75	185	70	85	125	80	5	62	145	72.5	110	15	0.06
103	47	4486	4000	40	75	90	220	85	105	150	105	5	78	175	87.5	130	20	0.1275
104	89	8495	3350	50	90	110	250	105	130	175	125	5	96	215	107.5	160	40	0.25
105	136	12982	2800	60	110	130	290	110	155	200	140	10	106	230	115	185	60	0.5
106	209	19950	2500	75	125	150	320	125	175	230	155	10	117	260	130	215	80	0.825
107	366	34936	2100	90	140	170	350	140	205	260	175	10	134	290	145	240	106	1.45
108	470	44864	1900	105	160	200	380	155	230	290	190	10	147	320	160	285	149	2.375
109	585	55841	1700	125	180	220	430	165	250	330	205	10	156	340	170	315	170	4.2
110	856	81709	1400	140	220	260	490	180	310	390	220	10	171	370	185	370	264	8.75

• Spacer Couplings also available on specific request.

## MATERIAL SPECIFICATIONS

Component	Size	Material	Grade	Standard
Hub	All Sizes	Forged Steel	EN9	St C-45
Sleeve	Sizes 100 - 106	EN9	St	BS970
Sleeve	Size 107 - 110	Cast Steel	St	-
O Ring	All Sizes	Synthetic Rubber	-	-
Gasket	All Sizes	Beta Flex	-	72 No
Hex Bolt	All Sizes	High Tensile	St	ISO 4014 : Gr 8.8



• For temperature range of elastomers please see on page no. 34 - coupling selection